

# PCI-4S-RS-R40

## 4-Slot Backplane with 3 PCI and 1 ISA Bus

User Manual Ver. 4.0

### 1. PW2: ATX Power Connector

Pin	Description	Pin	Description
1	+3.3Vdc	11	+3.3Vdc
2	+3.3Vdc	12	-12Vdc
3	GND	13	GND
4	+5Vdc	14	PS-ON
5	GND	15	GND
6	+5Vdc	16	GND
7	GND	17	GND
8	PWR-OK	18	-5Vdc
9	+5VSB	19	+5Vdc
10	+12Vdc	20	+5Vdc

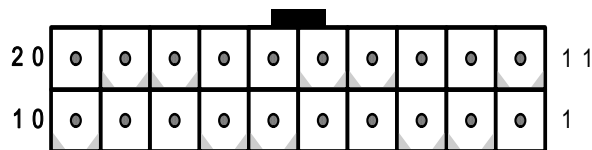

### 2. PW1: AT Power Connector

Pin	Description	Pin	Description
1	PWRGD	7	GND
2	+5V	8	GND
3	+12V	9	-5V
4	-12V	10	+5V
5	GND	11	+5V
6	GND	12	+5V

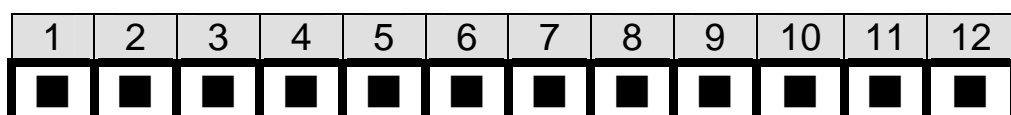

### 3. ATXCTL1: Backplane to Mainboard Connector

Pin	Description
1	GND
2	PSON#
3	5VSB

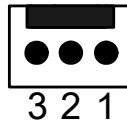

### 4. FAN1, FAN2: Fan Connector

Pin	Description
1	GND
2	+12V
3	NC

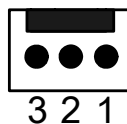

### 5. PCI routing table:

PCI ROUTING			
SIGNAL	PCI1	PCI2	PCI3
REQ#	REQ0#	REQ1#	REQ2#
GNT#	GNT0#	GNT1#	GNT2#
CLOCK	CLK0	CLK1	CLK2
IDSEL	AD31	AD30	AD29
INTA#	B	C	D
INTB#	C	D	A
INTC#	D	A	B
INTD#	A	B	C

**6. Notice:**

- a. Recommend to use 6mm width spacer to install

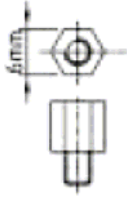

- b. Torsion must less than 6lb-inch

**7. Dimension:**

